



NUZEN
expect the next

CONVERTING MACHINERIES



REWINDER FEATURES

- + Differential Shaft Technology with Ball Type Quick Locks
- + Servo Controlled Drives for Complete Synchronization
- + Touch Screen Interface
- + Automatic Closed Loop Tension Control Throughout Varying Diameter and Speed
- + Servo Driven Laser Core Positioning System
- + Auto Reel Removing (Reel Thruster)
- + Swiveling Take Off Arms
- + Static Discharge System
- + Laser Core (optional)

UNWINDER FEATURES

- + Free Standing Unwinding Station
- + Shaftless Unwind
- + Parent Roll Ground Floor Pickup
- + Auto Expandable Core Chuck
- + Digital Edge/Line Web Guiding System
- + Closed Loop Tension Control Through Pneumatic Brakes Splicing Table
- + Touch Screen Interface
- + Adjustable Roll for Slack Web Correction
- + Dual Driven Unwinder* (optinal)



ADDITIONAL FEATURES

- + 'S - WRAP' Pull Roller
- + Bowed/Banana Roller for Wrinkle Free Web
- + Platform (walkway) for Easy Access of Cutter Section and Splicing Table
- + Manual Laser Core Positioning

MACHINE SPECIFICATION

- | | |
|----------------------|------------------------------|
| + Speed | : 600 mpm |
| + Maximum Web Width | : 1300 mm (1650 mm optional) |
| + Minimum Slit Width | : 50 mm (25 mm* optional) |
| + Rewinder Diameter | : 600 mm |
| + Rewinder Core ID | : 3" (6" optional) |
| + Unwinder Core ID | : 3" and 6" |
| + Unwinder Diameter | : 1100 mm |
| + Parent Roll Weight | : 1500 kgs |

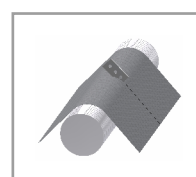

Groove Cut

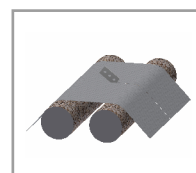

Air Cut

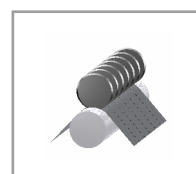

Roller Cut

GROUP OF COMPANIES



WORKING IN SINGLE COLOR WORLD



**500 + MACHINES ARE
UNDER OPERATION WORLD WIDE.**

● EXPORT TO
● OUR PRESENCE

EXPORTED TO

Due to high product standards and unmatched slitting quality, we have added our customers' list with global packaging giants as well. We currently export to United States of America, Chile, Brazil, Poland, United Kingdom, Italy, United Arab Emirates, Tunisia, Kuwait, Egypt, Oman, South Africa, Kenya, Tanzania, Zambia, Malawi, Botswana, Nigeria, Russia, China and are still growing.

OUR PRESENCE

RUSSIA – MOSCOW + EUROPE – FINLAND + EUROPE – ITALY + U.K. – ENGLAND

U.A.E. – DUBAI + AFRICA – TUNISIA + U.S.A. – SOUTH CAROLINA

LATIN AMERICA – CHILE + SOUTH AFRICA – JOHANNESBURG



KODY EQUIPMENTS PVT. LTD.

Survey No. 584/1 + 2 - A & B, Nr. Akshar industrial Estate, Hathijan Circle, Vatva, Ahmedabad 382445, Gujarat, INDIA.

Phone: +91 79 2584 0737, 6513 1345, 6523 1345 Mobile: +91 90999 40792, 90999 40793, 90990 71434

Email: export@kody.co.in / sales@kody.co.in / info@kody.co.in Website: www.kodyconverting.com

